

ANCHOR PRO PLUS

DESCRIPTION

Anchor Pro Plus is a two component, high strength, styrene free, chemical anchoring system. Designed as a fast curing system for very high loads, dynamic forces, critical and overhead fixings. Especially in corrosive environments, or damp conditions. ETA option 1 & 7 EAD approved (cracked and non-cracked concrete) and WRAS for use with drinking water applications.

PROPERTIES

- Ideal for overhead applications and all types of threaded rods and rebar from M8 to M24.
- Excellent adhesion to concrete, hollow brick, wood, plastic, metal and other construction materials.
- Safe, tested and certified according to ETA Option 1 and 7 EAD for applications in both cracked and uncracked concrete. CE approved with a guaranteed sustainability for 50 years.
- Tested and rated for fire applications and use with potable water.
- Fast curing – non drip that enables quick and efficient work.
- Designed for high strength, critical and dynamic loads. Even in wet concrete and fixations under water.
- High chemical resistance, especially in corrosive environments, or damp conditions.
- Easy to use with normal applicator guns without any need for special tools.
- Fire approval in ETA.
- Low shrinkage enables large diameter installations.
- Close edge distance and small spacing.
- Tested according to LEED 2009 EQ c4.1, SCAQMD rule 1168 (2005).

FIELD OF APPLICATION

- Excellent adhesion to concrete, wood, plastic, metal and other construction materials.
- Use with potable water.
- Used with all grades of threaded rod and rebar in accordance with TR029.
- Used for post installed rebar installations under TR029 and TR023.
- Used in non-cracked and cracked concrete.
- Used in dry and wet concrete and suitable for underwater applications.
- Used in critical or overhead applications
- Used in corrosive environments
- Used for elevated temperatures - temperature ranges I (ETA).



ANCHOR PRO PLUS – APP – 113

Art.no. 15520

Signature: JH

Date: 2023-02-17

This product information is property of VEIDEC AB and is not to be forwarded to third persons without our agreement. The product information has been made out according to our experiences; the corresponding distributing company has to point out probable characteristics as to the use of the product as the application fields are often very different. The recommendations as to technical use are not binding and do not justify any contractual relationship and subsidiary obligations under the contract of purchase. They especially do not relieve the buyer from testing our product on his own as to the suitability for the designated field of application.

ANCHOR PRO PLUS

USER INSTRUCTIONS

Surface should be clean, free of dust and grease.

Concrete & Hollow brick

1. Drill hole according to table using recommended load (kg) or seize (mm).
2. Blow, brush, blow x 4 times using Metal Brush (in a twisting motion) & Air Pump. Alternative you can use compressed air – blow-brush-blow x 2 times.
3. 1) Remove cartridge cap – notice that foil bag is already pre-cut, 2) fit cartridge with Anchor Mixer 15521, 3) insert cartridge in Alu Gun 15264 and **discard first 10 cm**.
4. **Concrete:** fill hole with 2/3 with Anchor Pro Plus.
Hollow Brick: 1) Put cap on nylon sleeve, 2) put nylon sleeve in hole and 3) fill 1/1 nylon sleeve with Anchor Pro Plus.
Internal sockets: fill hole with 3/4. Leave end-cap on socket to protect threads.
5. Insert fixing using a slow rotating motion to release trapped air.
6. After filling with Anchor Pro Plus. Leave mixer on cartridge as cap.
7. Follow minimum curing time in guidance for Anchor Pro Plus to cure and provide equivalent strength (90% of full strength). Fully cured after 24 h.

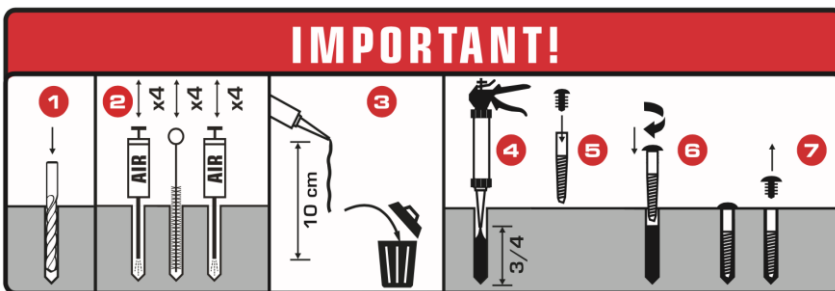
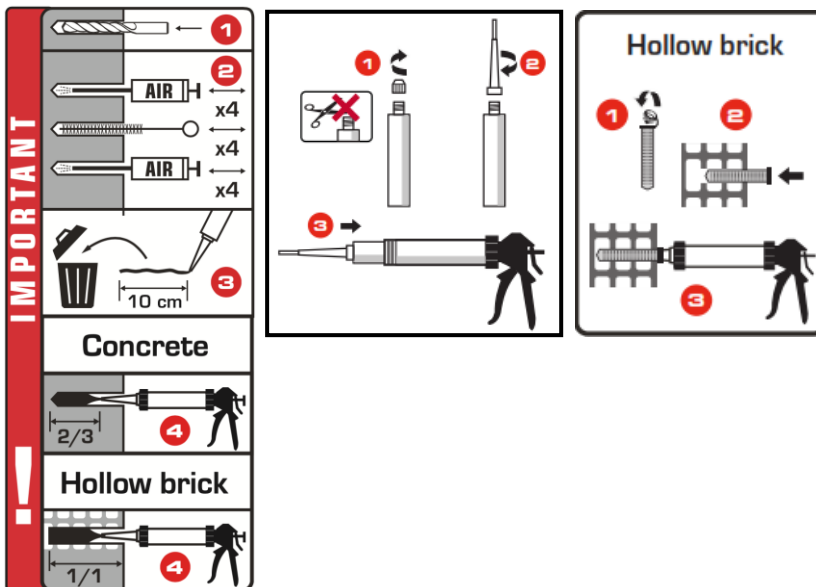

ANCHOR PRO PLUS – APP – 113

Art.no. 15520

Signature: JH

Date: 2023-02-17

This product information is property of VEIDEC AB and is not to be forwarded to third persons without our agreement. The product information has been made out according to our experiences; the corresponding distributing company has to point out probable characteristics as to the use of the product as the application fields are often very different. The recommendations as to technical use are not binding and do not justify any contractual relationship and subsidiary obligations under the contract of purchase. They especially do not relieve the buyer from testing our product on his own as to the suitability for the designated field of application.

ANCHOR PRO PLUS

TECHNICAL DETAILS

Color:	Grey vinylester resin.
Packaging:	300 ml (10:1 mixing ratio in pre-cut foil bag for use in normal cartridge system). Art.no. 15520
Accessories:	Anchor Mixer: Art.no. 15521 Alu Gun: Art.no. 15264
Odor:	Low.
Full curing time:	24 h.
Minimum curing time:	See chart below.
Density (20°C):	1,56 kg/m ³
VOC (directive 2010/75/EU):	10%
Gap fill:	20 mm.
Shelf life (temp.) months (+5 to +25°C):	18 months (avoid direct sunlight).
Compressive strength (EN ISO 604):	40,7 N/mm ²
Tensile strength (EN ISO 527 / ASTM 638):	9,8 N/mm ²
Flexural strength (EN ISO 178 / ASTM 790):	16,0 N/mm ²
Flexural Modulus (EN ISO 178 / ASTM 790):	1520 N/mm ²
Temperature resist (fully cured product):	-40°C to +40°C.
Application & Surface temperature:	-10°C to + 35°C (cartridge must be at least +20°C during application).
Certificates & Registrations:	CE, WRAS-BS6920 approved for use with potable water, Sunda Hus C-, Byggsvarubedömningen: avoided, BETA till BASTA, Fire reaction A1, Byggsvarudeklaration available, ETA Option 7, ETA-22/0744 for uncracked concrete with studs and rebar TR029, ETA Option 1, ETA-22/0744 for cracked concrete with studs, ETA-22/0746 for post installed Rebar with Fire.
Others:	In compliance with the legal regulations, please see current Material Safety Data Sheet. https://veidec.com/en/msds
User Instruction:	Scan the QR-code for MSDS, video and other information.



SYMBOLS

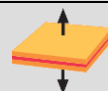

Tensile strength:
14,6 N/mm²

CERTIFICATES/REGISTRATIONS



Sunda Hus, Assessment C-.

BYGGVARUBEDÖMNINGEN

Byggsvarubedömningen, avoided.

BETA



BASTA

Anchor Pro Plus is registered by BETA till BASTA.



Approved for use with potable water.



Fire reaction: A1.

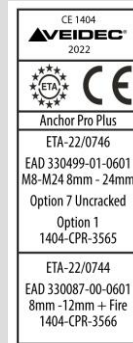

ETA Option 7 for uncracked concrete (M8-M24 / rebar dia. 8 to 25 mm).
ETA Option 1 for cracked concrete (M8-M24).



Intended use or uses of the construction product according to ETA-22/0744 & ETA-22/0746. Approved with a guaranteed sustainability for 50 years.

ANCHOR PRO PLUS – APP – 113

Art.no. 15520









Signature: JH

Date: 2023-02-17

This product information is property of VEIDEC AB and is not to be forwarded to third persons without our agreement. The product information has been made out according to our experiences; the corresponding distributing company has to point out probable characteristics as to the use of the product as the application fields are often very different. The recommendations as to technical use are not binding and do not justify any contractual relationship and subsidiary obligations under the contract of purchase. They especially do not relieve the buyer from testing our product on his own as to the suitability for the designated field of application.

ANCHOR PRO PLUS

Minimum curing time (cartridge temp at least +20°C). All specifications based on using our mixer 15521 – Anchor mixer.							 Time x2
Base material temperature	35	25	15	5	-5	-10	
Open time (mins)	3	5	9	20	40	50	
Min. load time (mins)	20	30	60	90	180	240	
Fully cured achieved after 24 h.							

Concrete								
Maximum load (kg)		Recommended load (kg)		Rod diameter	Hole drill diameter	Setting Depth	Spacing	Tightening Torque
Tension	Shear	Tension	Shear	mm	mm	mm	mm	Nm
								
1.900	900	910	510	M8	10.0	80	160	10
3.000	1.500	1.440	860	M10	12.0	90	200	20
4.300	2.100	2.100	1.200	M12	14.0	110	240	40
6.780	3.900	3.230	2.230	M16	18.0	125	320	80
10.460	6.100	4.990	3.490	M20	22.0	170	400	120
13.300	8.800	6.330	5.030	M24	28.0	210	460	160
18.200	14.250	8.670	8.140	M30	35.0	280	560	200
Concrete, fck, cube = 25N/mm ² (C20/25) 5.8 grade studding								

ANCHOR PRO PLUS – APP – 113

Art.no. 15520

Signature: JH

Date: 2023-02-17

This product information is property of VEIDEC AB and is not to be forwarded to third persons without our agreement. The product information has been made out according to our experiences; the corresponding distributing company has to point out probable characteristics as to the use of the product as the application fields are often very different. The recommendations as to technical use are not binding and do not justify any contractual relationship and subsidiary obligations under the contract of purchase. They especially do not relieve the buyer from testing our product on his own as to the suitability for the designated field of application.